

Prime Ag Land Information Summary

See attached "2023-09-29_LAFCO Soil Maps.pdf" exhibit

#1: The prime land area within the annexation area converted

The areas of Class I and Class II soils for each phase as well as the area of soil map unit 139 within the parcels are shown below.

Phase 1:

Class I: 0.39 acres

Class II: 0 acres

Total: 0.39 acres

Phase 2:

Class I: 5.55 acres

Class II: 0.51 acres

Total: 6.06 acres

Phase 3:

Class I: 0 acres

Class II: 0 acres

Total: 0 acres

Storie Index of 80 through 100 (Soil Map Unit 139) within proposed parcels (annexation area):
0.41 acres

#2: The prime area in the conservation areas that will be conserved in the ag easement.

The total areas of Class I and Class II soils within Lots 39-41 are as follows:

Lot 39:

Class I: 111 acres

Class II : 300 acres

Total: 411 acres

Lot 40:

Class I: 50 acres

Class II : 392 acres

Total: 442 acres

Lot 41:

Class I: 105 acres

Class II : 207 acres

Total: 312 acres

Total

Class I: 266 acres
Class II : 899 acres
Total: 1165 acres

#3: Any conversion of ag land defined by gov't code section 56064

None.

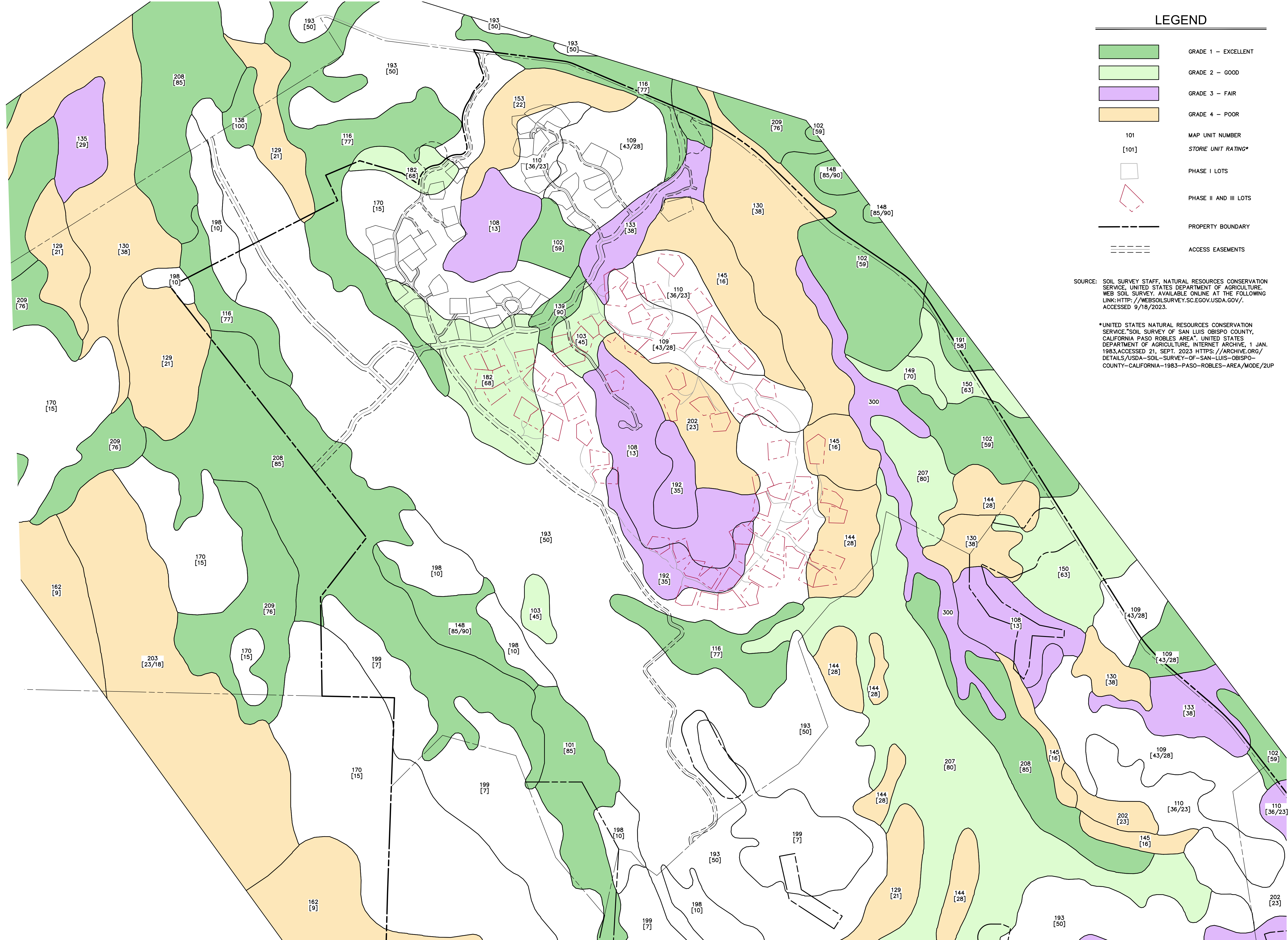

LEGEND

- GRADE 1 – EXCELLENT
- GRADE 2 – GOOD
- GRADE 3 – FAIR
- GRADE 4 – POOR
- MAP UNIT NUMBER
- STORE UNIT RATING*
- PHASE I LOTS
- PHASE II AND III LOTS
- PROPERTY BOUNDARY
- ACCESS EASEMENTS

SOURCE: SOIL SURVEY STAFF, NATURAL RESOURCES CONSERVATION SERVICE, UNITED STATES DEPARTMENT OF AGRICULTURE, WEB SOIL SURVEY, AVAILABLE ONLINE AT THE FOLLOWING LINK: [HTTP://WEBSOILSURVEY.SC.EGOV.USDA.GOV/](http://websoilsurvey.sc.egov.usda.gov/), ACCESSED 9/18/2023.

*UNITED STATES NATURAL RESOURCES CONSERVATION SERVICE "SOIL SURVEY OF SAN LUIS OBISPO COUNTY, CALIFORNIA PASO ROBLES AREA", UNITED STATES DEPARTMENT OF AGRICULTURE, INTERNET ARCHIVE, 1 JAN. 1983, ACCESSED 21, SEPT. 2023 [HTTPS://ARCHIVE.ORG/DETAILS/USDA-SOIL-SURVEY-OF-SAN-LUIS-OBISPO-COUNTY-CALIFORNIA-1983-PASO-ROBLES-AREA/MODE/2UP](https://archive.org/details/usda-soil-survey-of-san-luis-obispo-county-california-1983-paso-robles-area/mode/2up)

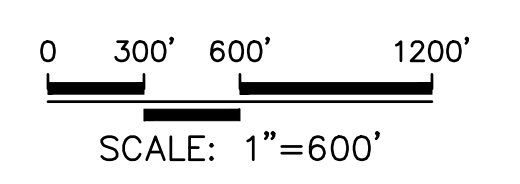
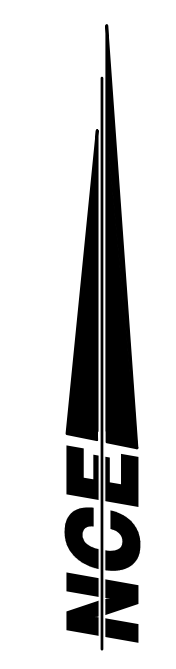

**TRACT 2586 - SANTA MARGARITA RANCH
LAFCO PRIME AGRICULTURAL
LAND EXHIBIT**

725 CRESTON ROAD, SUITE C
PASO ROBLES, CA
805.239.3127



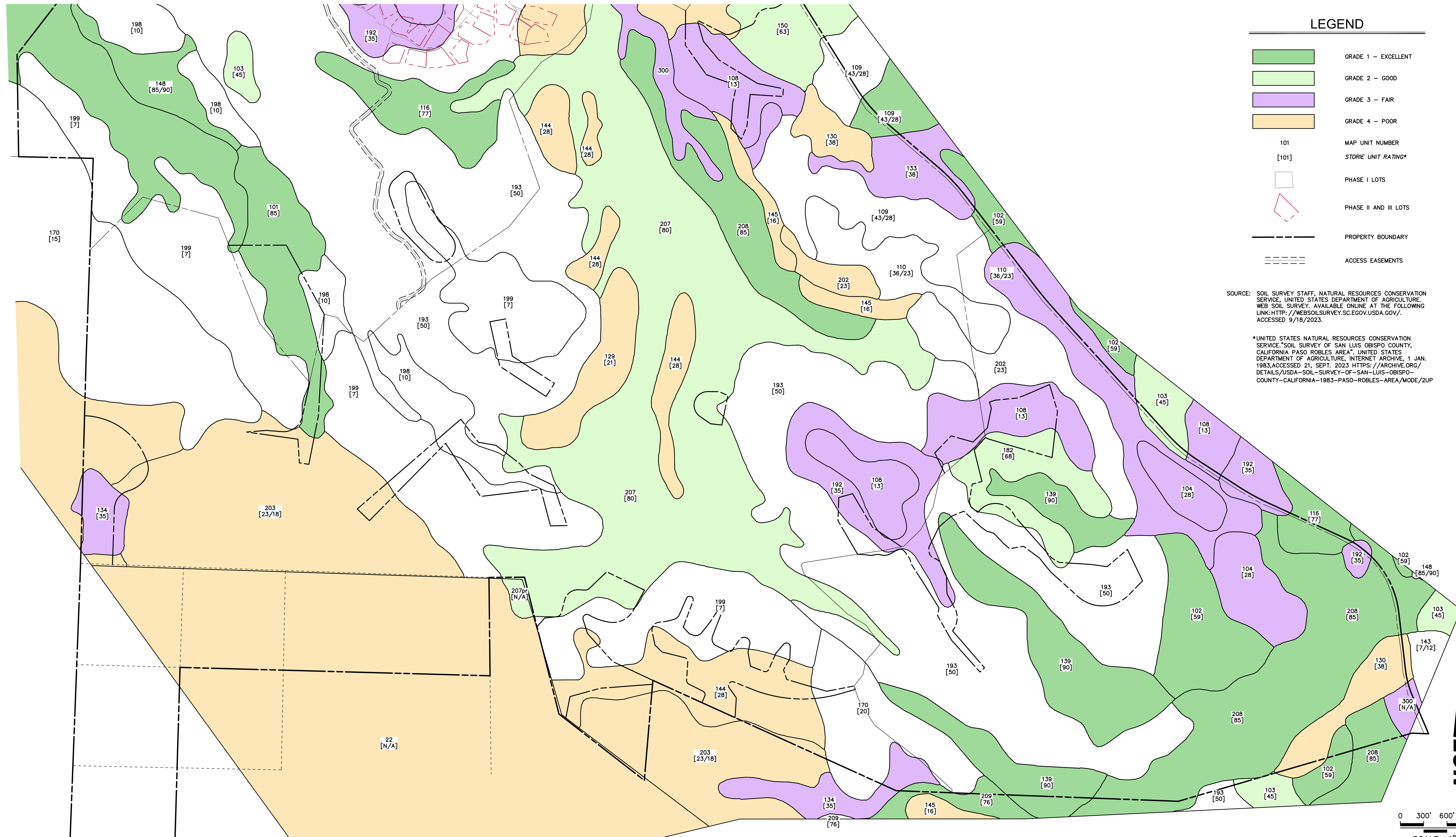

LEGEND

	GRADE 1 - EXCELLENT
	GRADE 2 - GOOD
	GRADE 3 - FAIR
	GRADE 4 - POOR
101	MAP UNIT NUMBER
[101]	STORIE UNIT RATING*
	PHASE I LOTS
	PHASE II AND III LOTS
	PROPERTY BOUNDARY
	ACCESS EASEMENTS

SOURCE: SOIL SURVEY STAFF, NATURAL RESOURCES CONSERVATION SERVICE, UNITED STATES DEPARTMENT OF AGRICULTURE, WEB SOIL SURVEY, AVAILABLE ONLINE AT THE FOLLOWING LINK: [HTTP://WEBSOILSURVEY.SCEGOV.USDA.GOV/](http://websoilsurvey.scegov.usda.gov/), ACCESSED 9/18/2023.

*UNITED STATES NATURAL RESOURCES CONSERVATION SERVICE "SOIL SURVEY OF SAN LUIS OBISPO COUNTY, CALIFORNIA PASO ROBLES AREA", UNITED STATES DEPARTMENT OF AGRICULTURE, INTERNET ARCHIVE, 1 JAN. 1983, ACCESSED 21, SEPT. 2023 [HTTPS://ARCHIVE.ORG/DETAILS/USDA-SOIL-SURVEY-OF-SAN-LUIS-OBISPO-COUNTY-CALIFORNIA-1983-PASO-ROBLES-AREA/MODE/2UP](https://archive.org/details/usda-soil-survey-of-san-luis-obispo-county-california-1983-paso-robles-area/mode/2up)

SCALE: 1"=600'

TRACT 2586 - SANTA MARGARITA RANCH
LAFCO PRIME AGRICULTURAL
LAND EXHIBIT

725 CRESTON ROAD, SUITE C
PASO ROBLES, CA
805.239.3127

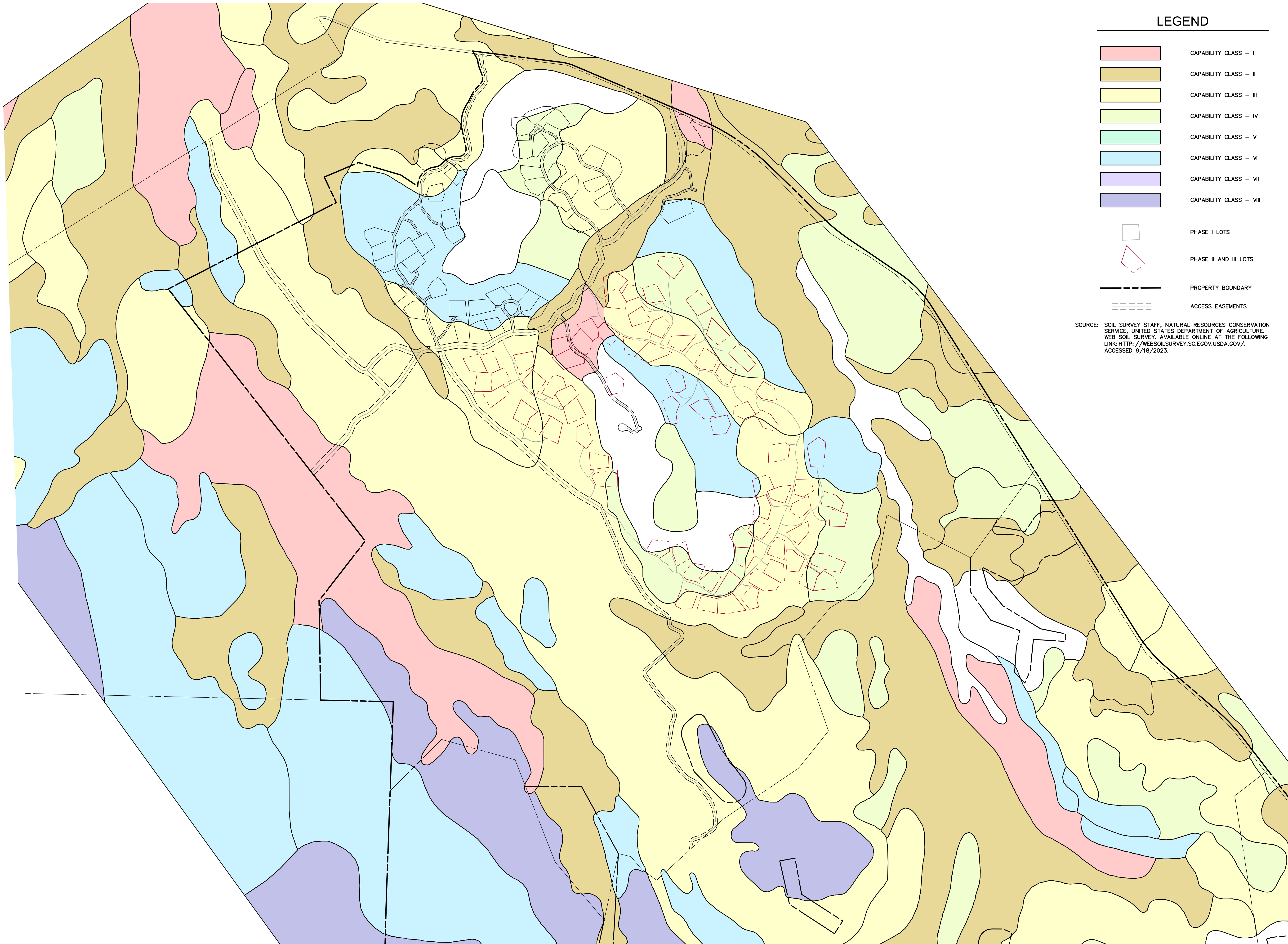

LEGEND

- CAPABILITY CLASS - I
- CAPABILITY CLASS - II
- CAPABILITY CLASS - III
- CAPABILITY CLASS - IV
- CAPABILITY CLASS - V
- CAPABILITY CLASS - VI
- CAPABILITY CLASS - VII
- CAPABILITY CLASS - VIII

- PHASE I LOTS
- PHASE II AND III LOTS
- PROPERTY BOUNDARY
- ACCESS EASEMENTS

SOURCE: SOIL SURVEY STAFF, NATURAL RESOURCES CONSERVATION SERVICE, UNITED STATES DEPARTMENT OF AGRICULTURE. WEB SOIL SURVEY. AVAILABLE ONLINE AT THE FOLLOWING LINK: [HTTP://WEBSOILSURVEY.SC.EGOV.USDA.GOV/](http://websoilsurvey.sc.egov.usda.gov/). ACCESSED 9/18/2023.

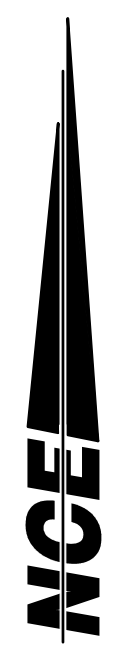

0 300' 600' 1200'
SCALE: 1"=600'

TRACT 2586 - SANTA MARGARITA RANCH IRRIGATED CAPABILITY CLASS

<p><small>725 CRESTON ROAD, SUITE C PASO ROBLES, CA 805.239.3127</small></p>	
--	--

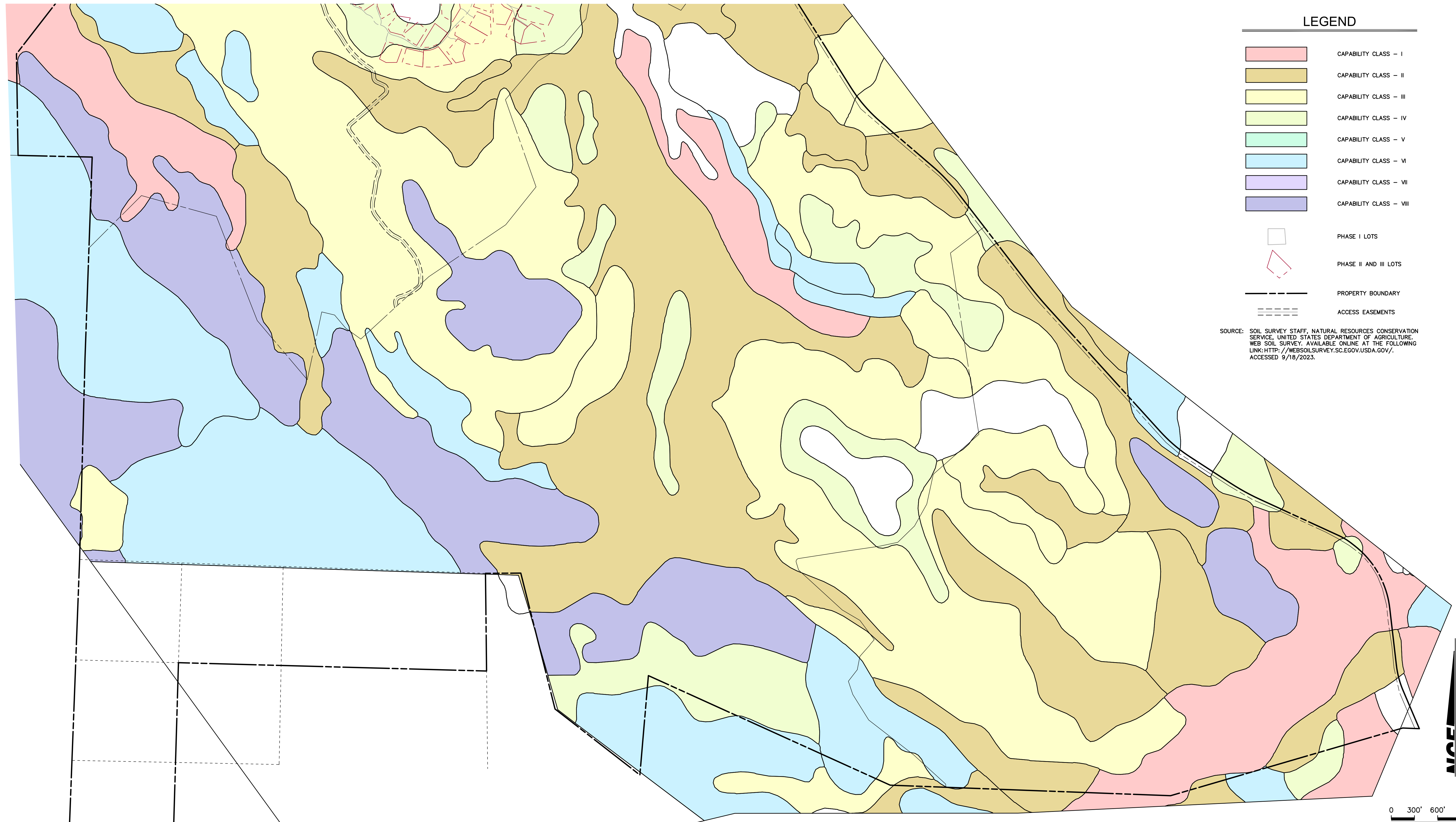

LEGEND

- CAPABILITY CLASS - I
- CAPABILITY CLASS - II
- CAPABILITY CLASS - III
- CAPABILITY CLASS - IV
- CAPABILITY CLASS - V
- CAPABILITY CLASS - VI
- CAPABILITY CLASS - VII
- CAPABILITY CLASS - VIII
- PHASE I LOTS
- PHASE II AND III LOTS
- PROPERTY BOUNDARY
- ACCESS EASEMENTS

SOURCE: SOIL SURVEY STAFF, NATURAL RESOURCES CONSERVATION SERVICE, UNITED STATES DEPARTMENT OF AGRICULTURE. WEB SOIL SURVEY. AVAILABLE ONLINE AT THE FOLLOWING LINK: [HTTP://WEBSOILSURVEY.SC.EGOV.USDA.GOV/](http://websoilsurvey.sc.egov.usda.gov/). ACCESSED 9/18/2023.

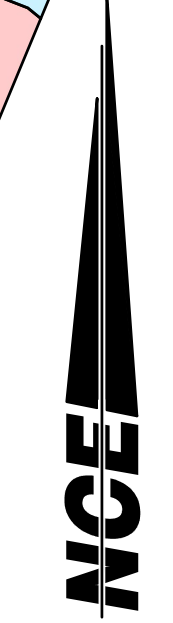
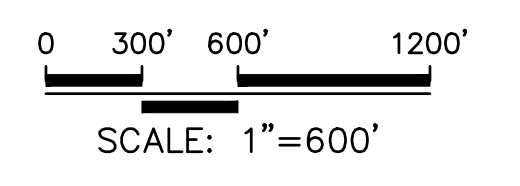

TRACT 2586 - SANTA MARGARITA RANCH IRRIGATED CAPABILITY CLASS

725 CRESTON ROAD, SUITE C
PASO ROBLES, CA
805.239.3127